



Service Bulletin: LF14000NN Installation

The LF14000NN lube filter for Cummins ISX, QSX, X12 and X15 engine applications have incorporated 2 variants of the threaded nutplate since July 2019. This results in minor variations to the turns required to engage seal to lube head surface prior to the $\frac{3}{4}$ turn of filter after gasket contact which is required to ensure a proper seal to the lube head. Cummins Filtration is continuing work to reduce these subtle changes that may be experienced. Customers are reminded to follow the instructions printed on the side of the filter shell and not rely on torque or feel for installation.

Installation of LF14000NN

To install the filters, regardless of nutplate variation:

1. Lubricate the gasket with clean engine oil prior to installation
2. Prefill the filter with clean engine oil.
3. Install filter by hand until the gasket makes contact to the lube head.
4. Tighten the filter an additional $\frac{3}{4}$ of a full turn using the printed "A B C D" markings on the can for reference.

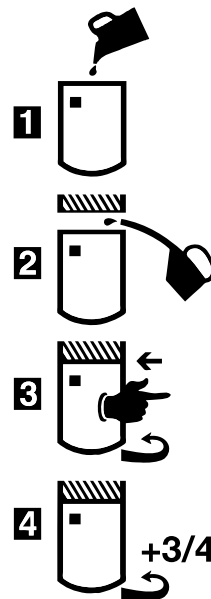

OEM Approved
Patent Approved and/or Pending



For more information, visit CumminsFiltration.com
©2020 Cummins Filtration Inc. MB10566

